

ML34HD1L4700-E

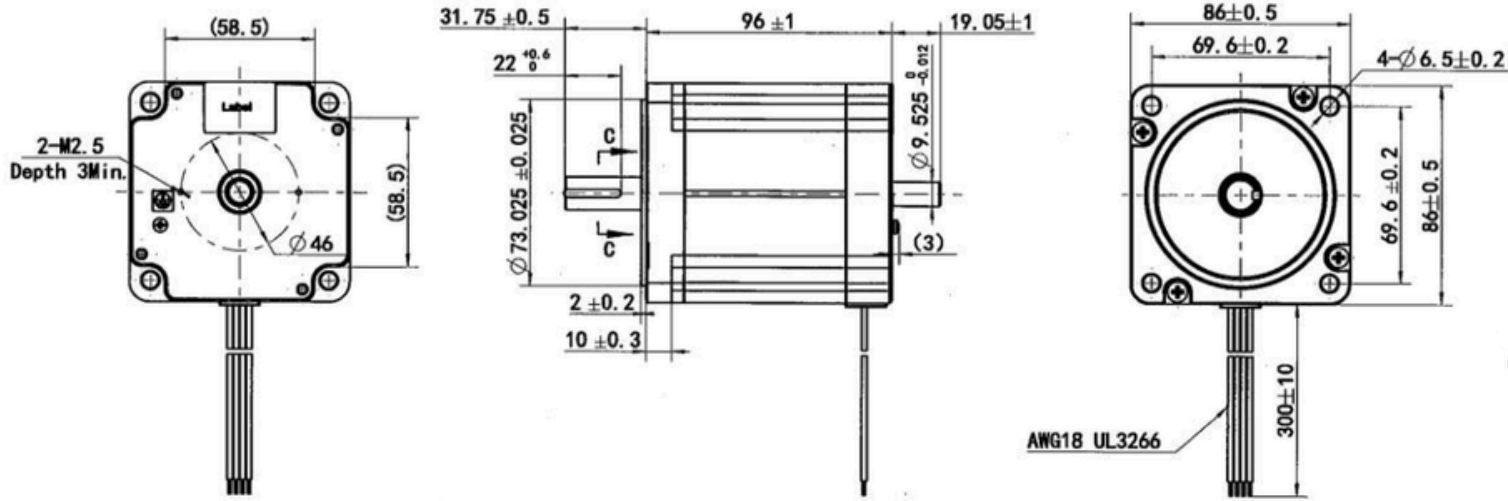

Wiring Diagram

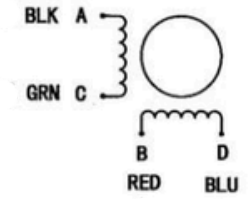

Exciting Sequence vs. Direction of Rotation

STEP	A	B	C	D	CCW
1	+	+	-	-	↑
2	-	+	+	-	
3	-	-	+	+	
4	+	-	-	+	

Clockwise view from mounting side

1. Number of Phase	2
2. Step Angle	1.8°
3. Rated Voltage	2.52 V DC
4. Rated Current	7 Amp
5. Holding Torque	7.2 Nm Typ. (Two phase on/rated current)
6. Phase Resistance	0.36 ± 0.1ohm (20°C)
7. Phase Inductance	4 mH ± 20% (1kHz 1V rms)
8. Rotor Inertia	1480 gcm ²
9. Motor Weight	2.7 kg
10. Insulation Class	B (130°C)

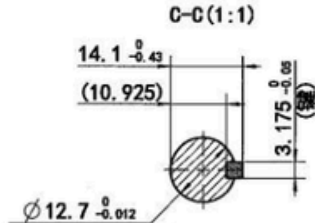

Label Detail (2:1)

XXXXXXX-Work order
 XXXX-Serial number



Date Format

Factory ID

REV.	REVISION RECORD	DATE	UNLESS OTHERWISE SPECIFIED	NAMES	SIGNATURE	DATE
A1	ECR:23-317, There are one positions	2023.03.29	Unit:mm First angle method Tolerances for linear and angular dimensions without individual tolerance indications GB/T 1804-m eqv ISO 2768-1:m Geometrical tolerance for features without individual tolerance indications GB/T 1184-K eqv ISO 2768-2:K	Approve		
A0	Original revision	2017.09.15		Standardize		
				Process Review		
				Check		
				Design		

PIVEXIN
TECHNOLOGY